



PRESSURE LOSS ALARM | DESCRIPTION

Pressure loss alarms are used to inform the user of an insufficient suction level due to blocked filters or malfunction of the suction motor / ventilator.

The advantages of having the pressure alarm installed is that you will always be able to change your filters on time and therefore have the optimal suction in your working place.

The unit consists of a sensor and a signal.

Rectus manufactures different kind of pressure loss alarms for different purposes including custom designs.

Please do not hesitate to contact us for advice and recommendations.

PRESSURE LOSS ALARM | FEATURES

Features of the pressure loss alarm include:

- ✓ Protects you and your system
- ✓ Various pressure areas
- ✓ Easy to install
- ✓ Small dimensions

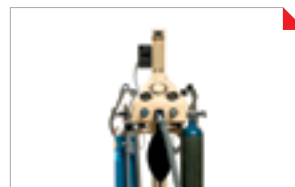

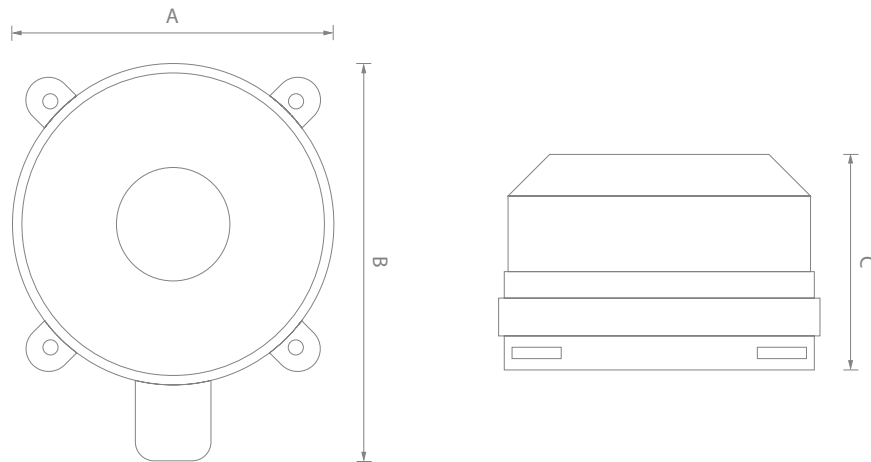

DIMENSIONS

PRODUCT	ITEM NO.	PRESSURE	WIDTH (A)	HEIGHT (B)	DEPTH (C)	WEIGHT
Pressure loss alarm	900860	20 - 200 Pa	85 mm	105 mm	57 mm	0,25 kg
Pressure loss alarm	900870	0,5 - 2,5 KPa	85 mm	105 mm	57 mm	0,25 kg
Dinitrogenoxid alarm	D5575	1,0 - 2,5 KPa	68 mm	105 mm	25 mm	0,2 kg

RELATED PRODUCTS



PRODUCT PAGE NO.

Hyaline SA 01



PRODUCT PAGE NO.

Superflex SA 02



PRODUCT PAGE NO.

CP Suction motors SM 03



PRODUCT PAGE NO.

CP Ventilators SM 04



PRODUCT PAGE NO.

G-Box SD 01



PRODUCT PAGE NO.

Workbench WP 01