



BONDING PLATE | DESCRIPTION

The Bonding Plate is a mixing plate with suction, which can be connected to the unit's high volume suction.

Handling and mixing materials during treatment could lead to a demand for process ventilation in the clinic. Often the demand is difficult to fulfill due to existing inventory and technical conditions of the buildings.

The physical conditions in the cabinet are also a problem, as many mixing drawers do not have enough space for more than the most necessary materials and equipment.

The advanced technology of the turbo mouthpiece, provides a strong ventilation of the area, where the materials are mixed. The air speed over the area to be used for mixing is approx. 0,2-0,5 m/sec. The plate can easily be dismounted after use.

BONDING PLATE | FEATURES

Features of the bonding plate include:

- ✓ Easy to install
- ✓ Fits in everywhere
- ✓ Small dimensions
- ✓ Efficient suction

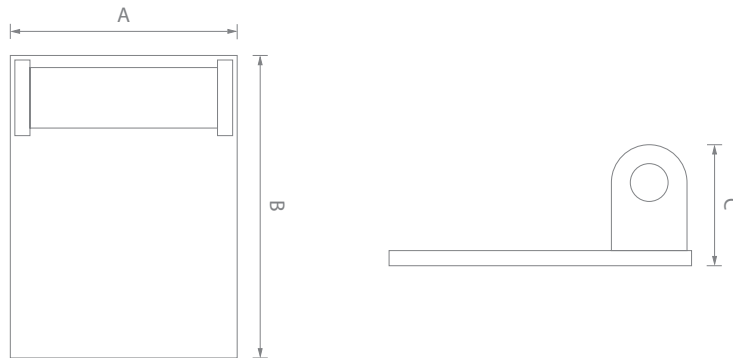

DIMENSIONS

| PRODUCT | ITEM NO. | WIDTH (A) | HEIGHT (B) | DEPTH (C) | OUTLET | WEIGHT |
|---------------|----------|-----------|------------|-----------|---------|--------|
| Bonding plate | 901118 | 150 mm | 200 mm | 80 mm | Ø 60 mm | 1,1 kg |

RELATED PRODUCTS



| PRODUCT | PAGE NO. |
|---------|----------|
| Hyaline | SA 01 |



| PRODUCT | PAGE NO. |
|-------------------|----------|
| CP Suction motors | SM 03 |



| PRODUCT | PAGE NO. |
|-----------|----------|
| Superflex | SA 02 |



| PRODUCT | PAGE NO. |
|---------|----------|
| G-Box | SD 01 |